

Saliva Cassette Drug Test Instructions

PACKAGE CONTENTS

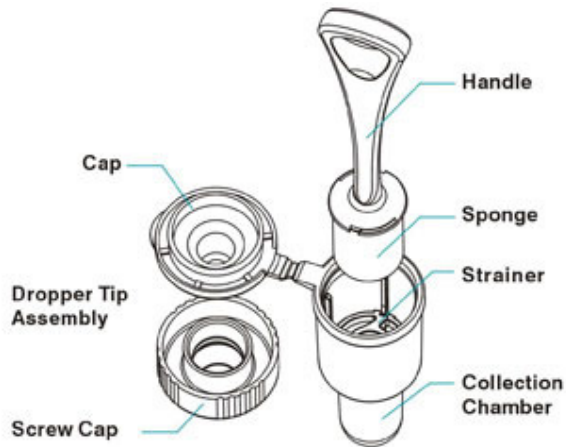

STEP ONE

Instruct the donor to not place anything in the mouth including food, drink, gum or tobacco products for at least 10 minutes prior to collection.

STEP TWO

Remove the collector from the sealed pouch and insert the sponge end of collector into mouth; actively swab the inside of the mouth and tongue with sponge. As soon as the sponge softens slightly, the donor should gently press the sponge between the tongue and teeth to ensure complete saturation; the sponge is saturated when no hard spots can be detected. Collect for a total of 3 minutes before removing sponge. The donor should hand the saturated collector to the tester.

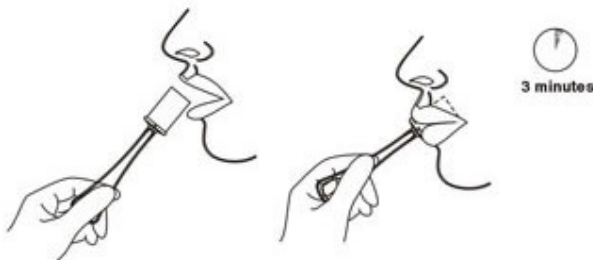

STEP THREE

Flip open the dropper tip of the oral fluid collection tube (do not twist open the screw cap at this time). Place the saturated oral fluid collector into the collection chamber and press the sponge firmly down on the plastic strainer to release as much liquid as possible.



STEP FOUR

Snap the dropper tip shut on the collection tube. Unscrew the cap to expose the dropper tip.

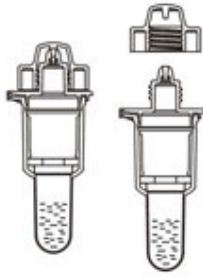

STEP FIVE

Invert the collection tube and transfer 3 drops of oral fluid (approximately 100 μ L) into each sample well of the test device and start the timer. Avoid trapping air bubbles in the specimen well. Twist the screw cap back onto the collection tube.

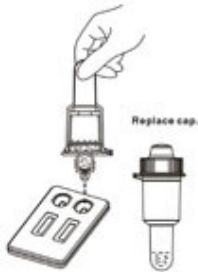

STEP SIX

Read results at 10 minutes. Do not read results after 1 hour.

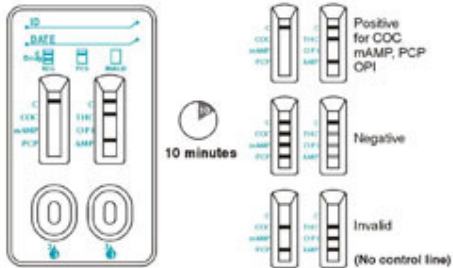

STEP SEVEN

If positive results are observed, apply the security seal over the screw cap and send the device to a laboratory for confirmation. The laboratory can access leftover fluid from the collection chamber.

